

## **PIENAAR ENERGY (PTY) LTD**

# **How to connect the battery to the signal base station**



## How to connect the battery to the signal base station

---



### Gigaset C385

Connecting the base station x First connect the mains adapter 1. x Then connect the tele-phone jack 2 and insert the cables into the cable ducts.

[Get Price](#)

## Common ways to set up a base station

Each day, mount the GNSS antenna on the GNSS end of the T-Bar and the radio antenna on the radio end of the T-Bar. Connect the antennas to the receiver using the appropriate ...



[Get Price](#)



### V5 user manual-PYTES 1.3

Pytes V Series LFP Battery User Manual  
Dear valued customer, Thank you for purchasing our Pytes V series LFP battery for home energy storage system. Our V series battery ...

[Get Price](#)

## Pytes V Series LFP Battery

## User Manual

Discover detailed specifications and instructions for the V Series LFP Battery, model PHOENIX C-ES-FTB 25-70. Learn about installation, operation, maintenance, communication ...

[Get Price](#)



## How to install batteries in signal base stations

How to install batteries in signal base stations What makes a telecom battery pack compatible with a base station? Compatibility and Installation Voltage Compatibility: 48V is the standard voltage for ...

[Get Price](#)

## V5 user manual-PYTES 1.8-20250807

Next connect the positive and negative terminals of the battery port of energy storage inverter to one of the batteries with power cables. But due to limitations in battery communication and ...

[Get Price](#)



## Base Station Quick Guide

The installation area of the base station should be at least 200m away from any high-power radio sources (such as TV

stations, microwave stations, etc.), and at least 50m away from ...

[Get Price](#)



---

## How to Connect a Base Station Lithium Battery to an Inverter: A ...

How to Connect a Base Station Lithium Battery to an Inverter: A Step-by-Step Guide Why Proper Connection Matters for Telecom and Energy Storage Systems Connecting lithium batteries to ...

[Get Price](#)



---

## How to match batteries with signal base stations

Which battery is best for telecom base station backup power? Among various battery technologies, Lithium Iron Phosphate (LiFePO4) batteries stand out as the ideal choice for telecom ...

[Get Price](#)



---

## Base Station (Gen 3) Overview and Installation Guide

OverviewThe Base Station is the brains

of your system. It sends alarm signals to the monitoring center\* with built-in cellular and Wi-Fi connections, a battery backup that lasts up to 24 hours, and

[Get Price](#)

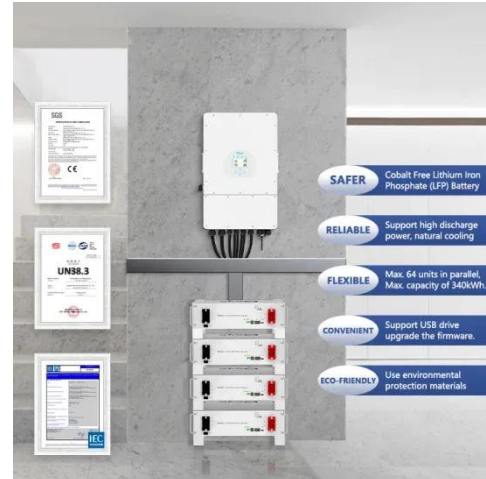

## Contact Us

For catalog requests, pricing, or partnerships, please visit:  
<https://pienaarshof.co.za>

